

03

# Divisions' cluttered corridor problems and interventions

# Tampines North

## Public Education + Outreach Efforts

**Problem** | Various items contributed to the cluttered corridors, ranging from swings, sofa sets, playpens and shoe racks to bamboo laundry poles and car tires. The issue is most pronounced in ground floor units and in square corridors where multiple units share a common space.

**Intervention** | A Dragon Mascot named 'Clear up Corri' will be used in posters, leaflets, decals, pull-up banners, and social media to convey the message to residents to keep at least 1.2m of the common corridors' width clear of clutter. The posters, leaflets and decals will be placed in the lift / at lift lobbies. The project is targeted to launch via the National Day event at the CC where pull-up banners will be placed. Additionally, one possible avenue would be to partner with schools around Tampines North area as part of students' VIA project where the students can help to manage social media accounts to spread the message.

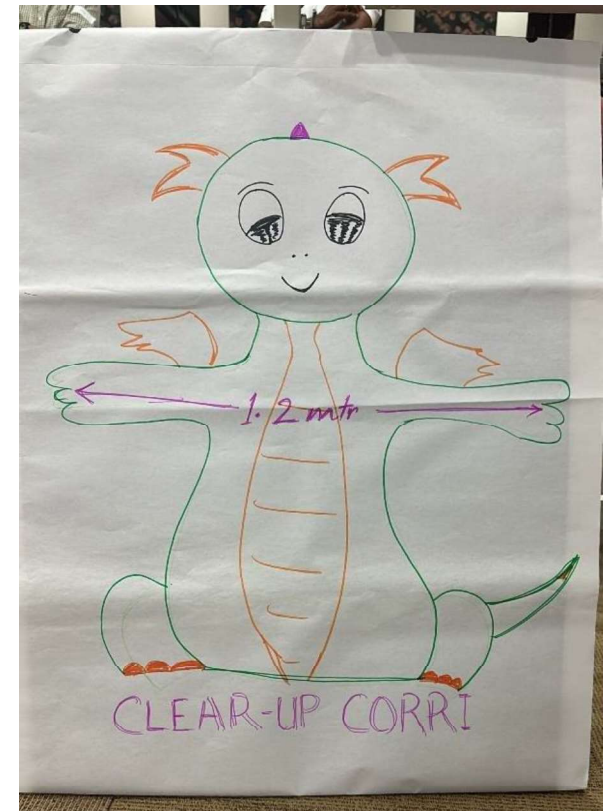

# Kreta Ayer – Kim Seng

## Public Education

**Problem** | The corridors in rental blocks often get cluttered as tenants tend to leave their items along the corridors. Elderly residents, who love gardening, tend to have more potted plants along the corridors. This clutter makes it difficult for emergency services to move through when needed. Examples of clutter include large potted plants, furniture, 'karang guni' items.

**Intervention** | Paste floor decals outside the lift lobby on every floor. The decal will be sized to a hospital bed, to showcase smooth passage through the corridor. The message emphasises social responsibility by urging residents to make space along the corridors, highlighting the mutual reliance among neighbours.

Note: no participants from this division attended workshop 3

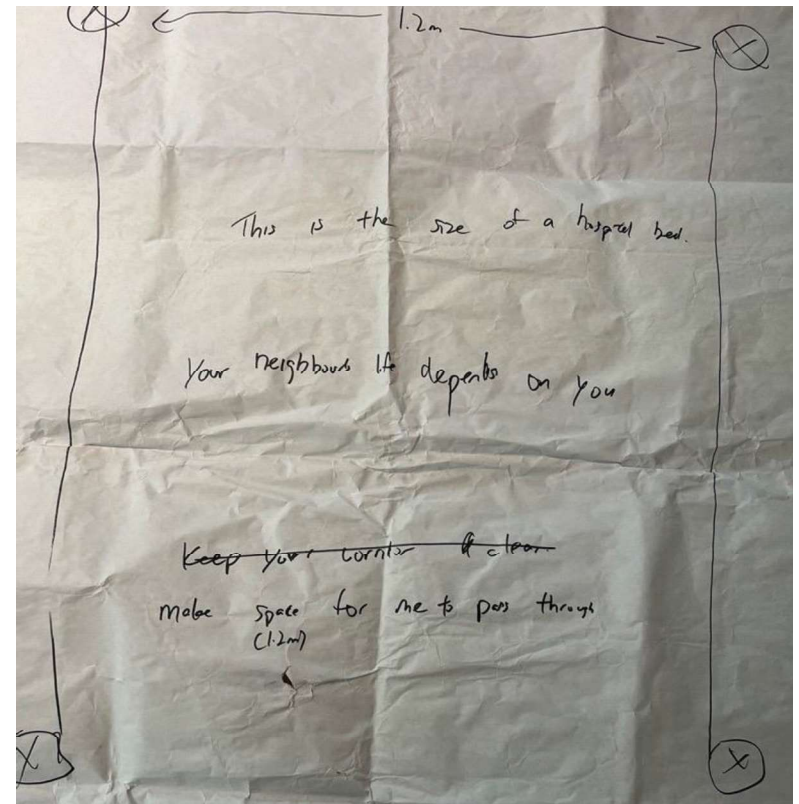

# Zhenghua

## Outreach Efforts

**Problem** | Residents with lower incomes and those residing in rental flats tend to clutter the corridors more frequently, primarily due to limited space within their homes. Additionally, there are residents who enjoy collecting second-hand items, further contributing to the clutter. Examples of clutter include tables, plants and bicycle.

**Intervention** | Prior to the main event, a simulated evacuation will be conducted in partnership with SCDF and will be video recorded. Residents will also receive a 1.2m measuring tape. These pre-event efforts are aimed at raising awareness about the upcoming Christmas Emergency Preparedness Day, the main event. During the main event, a simulated emergency evacuation will take place, accompanied by children's activities such as navigating clutter obstacle courses, and learning about fire safety. Additionally, a 'karang guni cash for trash' flea market concept will be featured. The event will also address the importance of keeping corridors clear.

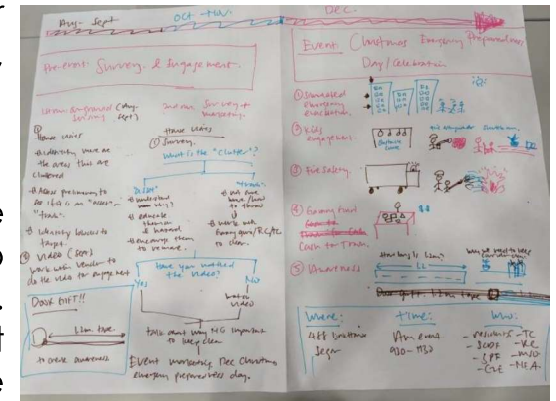

# Toa Payoh East & Tanjong Pagar-Tiong Bahru

## Public Education + Outreach Efforts

**Problem** | The elderly are prone to cluttering corridors, often due to their enjoyment of planting. Additionally, some individuals face space constraints within their units, leading them to place items intended for sale in the corridors. This clutter presents challenges for emergency services trying to access specific units. Examples of clutter include plants and second-hand items.

**Intervention** | Paste decals on floors and the outer face of lift doors on every floor. Additionally, there will be a community event which will start with a lighthearted video introduction of the cluttered corridors problem and its implications. The event agenda will include an advisor's speech, an obstacle course activity, a flea market, and booths with insights from partner agencies like NEA and MSO. Attendees will receive a goodie bag which will contain a 1.2m measuring tape.



# Bishan East-Sin Ming

## Public Education + Outreach Efforts

**Problem** | Cluttered corridors is most commonly observed at older estates and rental flats. Older estates have a higher population of elderly residents, who are most likely to make use of the common spaces. Meanwhile, residents of rental flats, constrained by limited storage within their units, resort to leaving items in corridors. Examples of clutter include potted plants, furniture, bicycles, scooters and prams.

**Intervention** | Paste decal on lift doors and on the floor outside ground floor lifts. The decals will include a tagline “Clean and clear corridors, safe spaces for all”, promoting safety and consideration towards others and highlighting common clutter. Additionally, residents can engage in a simulation of navigating wheelchairs or strollers through clutter. The tagline will be reiterated, highlighting the necessity of maintaining clear pathways, including staircases, landings, lift lobbies, doorways, and dry/wet risers.



# Kolam Ayer

## Outreach Efforts

Problem		Rental flats bear the brunt of the issue, primarily due to limited storage space within their units due to the high number of occupants per unit. Furthermore, individuals with disabilities face challenges finding space within their flats to park their personal mobility devices (PMDs), as they require immediate access to them for travel.
Intervention		There will be a publicity event featuring an emergency drill. Residents will be encouraged to tidy up corridors prior to an enforcement check, ensuring they are prepared and not caught off guard. The emergency drill will involve a role-play of SCDF having to rescue a unit where the corridor is cluttered.

Note: no participants from this division attended workshops 2 and 3

# Woodgrove

## Outreach Efforts

Problem	Several units exhibit a concerning trend of bicycles being parked along the corridors and adjacent to the lift areas. This is due to previous theft incidents when bicycles were left downstairs at the ground floor. There was also the presence of various other items cluttering the corridors, such as renovation equipment, religious artefacts, potted plants, and PMDs.
Intervention	A roadshow will be set up in conjunction with the National Day Observation Ceremony. The roadshow will include an emergency drill where the SCDF will announce a fire breakout within one of the flats. Tangible objects, such as shoe racks, will be placed along the corridor to showcase a realistic demonstration, alongside a marked corridor path and physical partition ensuring a designated 1.2m wide pathway. Virtual Reality (VR) may also be explored for the event. The messaging will underscore the importance of the 1.2m rule, citing its relevance for emergency preparedness and facilitating movement for seniors, parents with prams, and wheelchair users in the corridors. This event will be promoted to residents via social media (Instagram, Telegram) and flyers at lift landing of blocks.